

VDS 219 C

19" MARINE MONITOR



video display systems



Specifically designed for inside applications, the VDS 219 C display provides a standard SXGA 19" LCD/TFT panel in a robust and essential enclosure. Robustness, simplicity in installation and operation make it ideal for environments where reliability, space optimization and effectiveness demands are very high.

HIGHLIGHTS

- ▼ INSIDE APPLICATIONS
- ▼ EASY INSTALLATION
- ▼ WIDE OPERATING VOLTAGE RANGE
- ▼ TOUCHSCREEN VERSION AVAILABLE
- ▼ COMFORTABLE IN EVERY LIGHT CONDITION
- ▼ MULTIPLE VIDEO INPUTS
- ▼ MULTI-PANEL DIMMING

Technical Specifications

DISPLAY

Active area:	376(h) × 301(v) mm
Backlight lamps:	4 CCFL
Bonded safety glass:	Bonded, contrast enhancing, optically coated (optional)
Colors:	16.7 M
Contrast:	1300:1 (typ)
Dimming:	Max ÷ 0
Dot pitch:	0,294 mm
Luminance:	300 cd/m ² (typ)
Minimum lamps life:	50000 hours
Resolution:	1280 x 1024 pixels (SXGA)
Response time:	20 ms
Safety glass:	Clear glass
Size:	19"
Type:	LCD TFT color
Viewing angles:	± 89° / ± 89° (h/v)

ENVIRONMENT

Enclosure IP rating:	IP 20
Front frame IP rating:	IP 65
Operating temperature:	-5 ÷ 55 °C
Relative humidity (non condensing):	20 ÷ 80 %
Storage temperature:	-20 ÷ 60 °C

INPUT SIGNALS

1x VGA 15 pin, High Density, D-SUB, female

PHYSICAL DATA

Mounting type:	Console/Flush
Overall dimensions:	435(h) × 380(h) × 79(d) mm
Weight:	7 Kg

POWER SUPPLY

Max consumption:	3A @ 24 Vdc
Power supply connector:	PHOENIX COMBICON MSTB 2,5/3-G-5,8
Voltage range:	15 ÷ 35 Vdc

VDS 219 C

19" MARINE MONITOR



video display systems

Wall Mounting

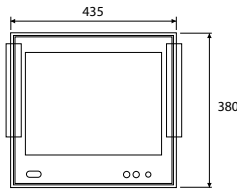

FRONT VIEW

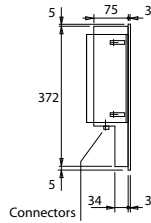

SIDE VIEW

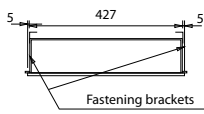

TOP VIEW

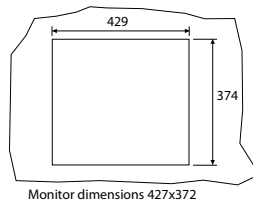

PANEL CUT OUT

Options and Accessories

Trackball

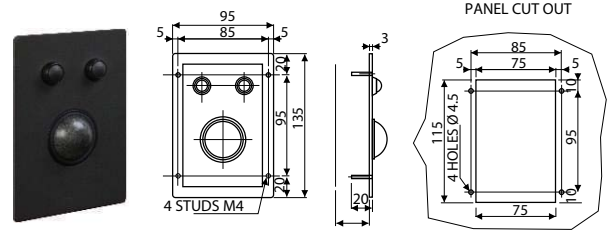

Specifications (basic version)

Sphere diameter:	38mm
Interfacing:	USB port
Connector:	USB type
Operating temperature:	-5°C+55°C
Storage temperature:	-20°C+60°C
Expected life:	>1 million sphere revolutions
Waterproofing degree:	IP60

OPTIONS

Waterproofing degree:	IP67
-----------------------	------

VDS trackballs provide a convenient and robust pointing device for inside applications (IP60 compliant version) as well as outside applications (IP67 compliant version).

Ordering Codes

VDS 219 C basic version

M219C VDS 219 C display 19", 24Vdc, 1xVGA, Console brackets

OPTIONS

Any of the following:

- M0030** 2nd VGA input
- M0053** 15-35 Vdc isolated power supply
- M0084** 19" Bonded optical coated safety glass

One among the following:

- M0061** RS-232/RS-422/RS-485 port for PC interface
- M19T5** 19" resistive touch screen

One among the following:

- M0041** 1 PAL/NTSC input
- M0042** 2 PAL/NTSC inputs
- M0043** 3 PAL/NTSC inputs
- M0044** 4 PAL/NTSC inputs